

MPA-1516

GPS/GLONASS ACTIVE EMBEDDED ANTENNA

Ordering Part #: 189-00001-31

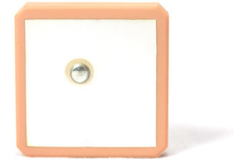

Description

Our patch antenna offerings are perfect for projects with a smaller scope and budget for which high-performance and lower weight is not a primary factor for consideration for the antenna. They are ideal for less demanding applications where extreme performance and battery life can be sacrificed at the expense of device cost. This antenna is designed for embedded applications such as GPS handheld units, mobile devices, and tracking devices. It features higher upper hemisphere efficiency and a lower axial ratio as compared to regular patch antennas. The interface connector is a through pin solution.

Mechanical Specifications

dimensions are in mm

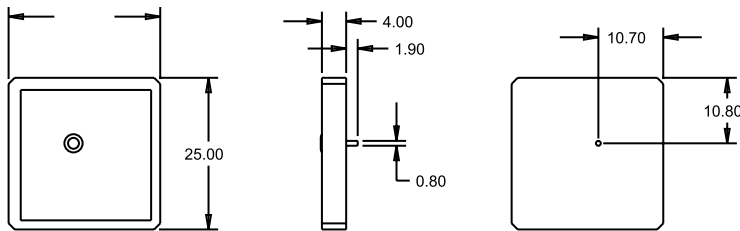

Electrical Specifications

25 x 25 mm ground plane

Parameter	Design Specifications
Frequency	1575 MHz (GPS) 1602 MHz (GLONASS)
Polarization	RHCP
Efficiency	90%
Realized gain	5 dBic
Axial ratio	3 dB
Bandwidth (-1db)	20 MHz
Beamwidth (3dB)	100° (both axes)
VSWR	1.5:1
Impedance	50 Ohm
Operating temp.	from -40°C to 85°C

Features

- GPS & GLONASS coverage
- Custom cable/connector options
- Compact size
- Custom tuning

Applications

- Vehicle and fleet tracking
- Military & security
- Asset tracking
- Embedded applications
- Oil & gas industries
- Navigation devices
- Mining equipment
- LBS & M2M applications
- Handheld devices
- Law enforcement